

## Saddle Eye Strap

**Material:** Stainless Steel

**Class Grade:** A2-70 G304

**Corrosion Protection Level:** Excellent

**Comments:** This product range is not rated and has no markings. Breaking load information provided is to be used as a guide only

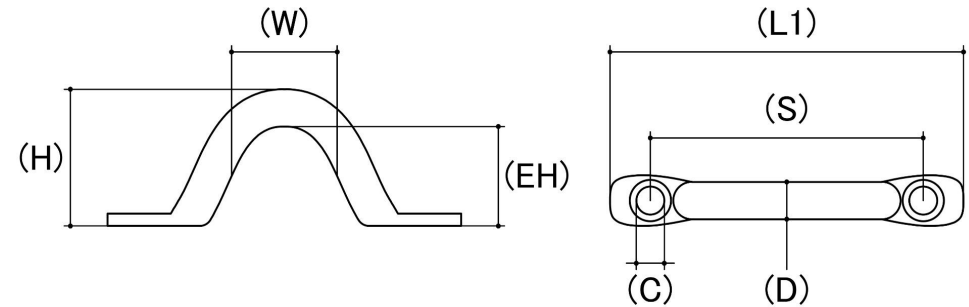

*Cad Drawings shown for graphic representation only.\**

| Size | Length L (1)<br>(mm) | Height Overall (H)<br>(mm) | Height Of Eye (EH)<br>(mm) | Holes Centre To Centre (S)<br>(mm) | Saddle Inside Width (W)<br>(mm) | Hole Size (C)<br>(mm) | sku<br>(Part Number) |
|------|----------------------|----------------------------|----------------------------|------------------------------------|---------------------------------|-----------------------|----------------------|
|      |                      | Nom                        | Nom                        | Nom                                | Nom                             | Nom                   |                      |
| 4mm  | 40.00                | 16.00                      | 11.00                      | 32.00                              | 10.00                           | 3.20                  | 62SES440             |
| 5mm  | 51.00                | 16.00                      | 13.00                      | 40.00                              | 11.00                           | 4.00                  | 62SES551             |
| 6mm  | 57.00                | 22.00                      | 16.00                      | 44.00                              | 14.00                           | 5.20                  | 62SES657             |
| 8mm  | 63.00                | 25.00                      | 17.00                      | 47.00                              | 11.00                           | 5.20                  | 62SES863             |

**Disclaimer:**

Dimensional data and technical information was obtained from publically available sources and not acquired through standard agencies. It has been completed and compiled for reference purposes only; where discrepancies are found they are subject to change without notice. Bolt & Nut Australia makes no warranties or representations regarding the accuracy and validity of the compiled information and data. Contact the relevant standard authorities for accurate and detailed information.

\* Cad Drawings may not reflect diameter, thread length or overall length.

© Bolt & Nut Australia Pty Ltd. All rights reserved.

Version: 23 Sep 2024